

DELLE PIU' IMPORTANTI TURBINE COSTRUITE IN ITALIA

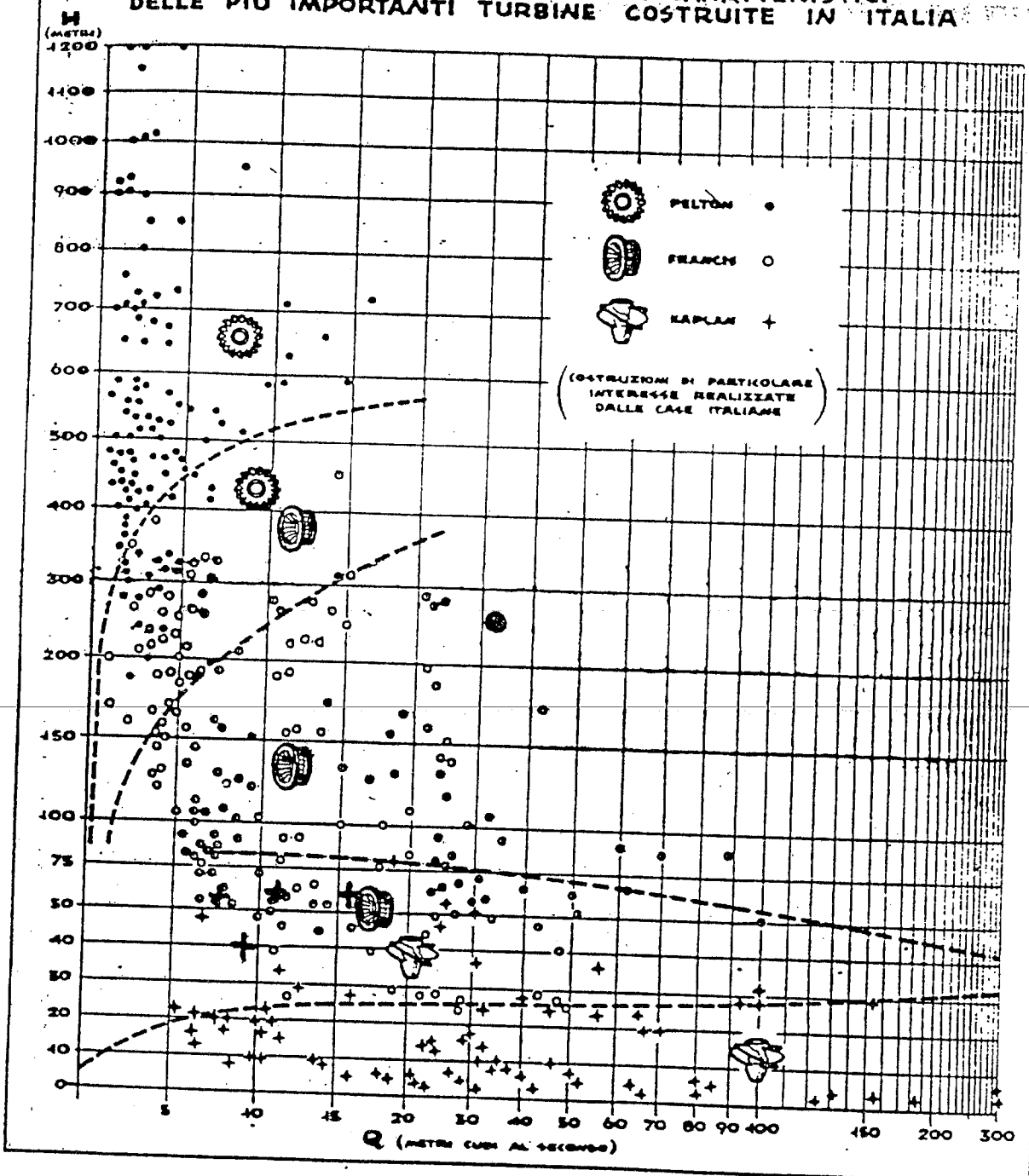

Fig. 8.5. Evoluția formei geometrice a rotorului cu tur. specifică.

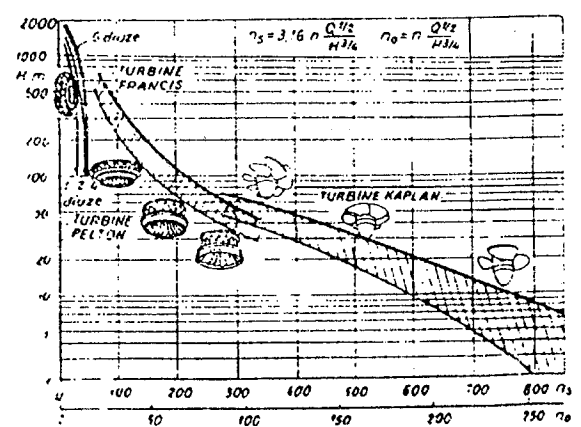
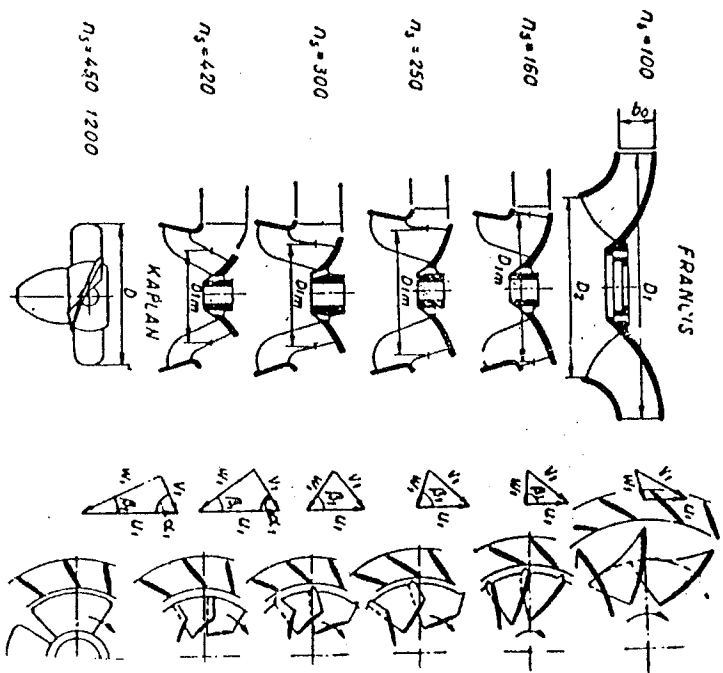

Fig. 2.1. Domeniul de funcționare a turbinelor.

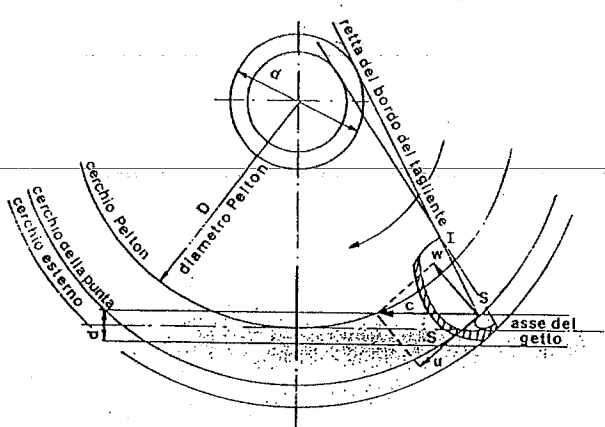
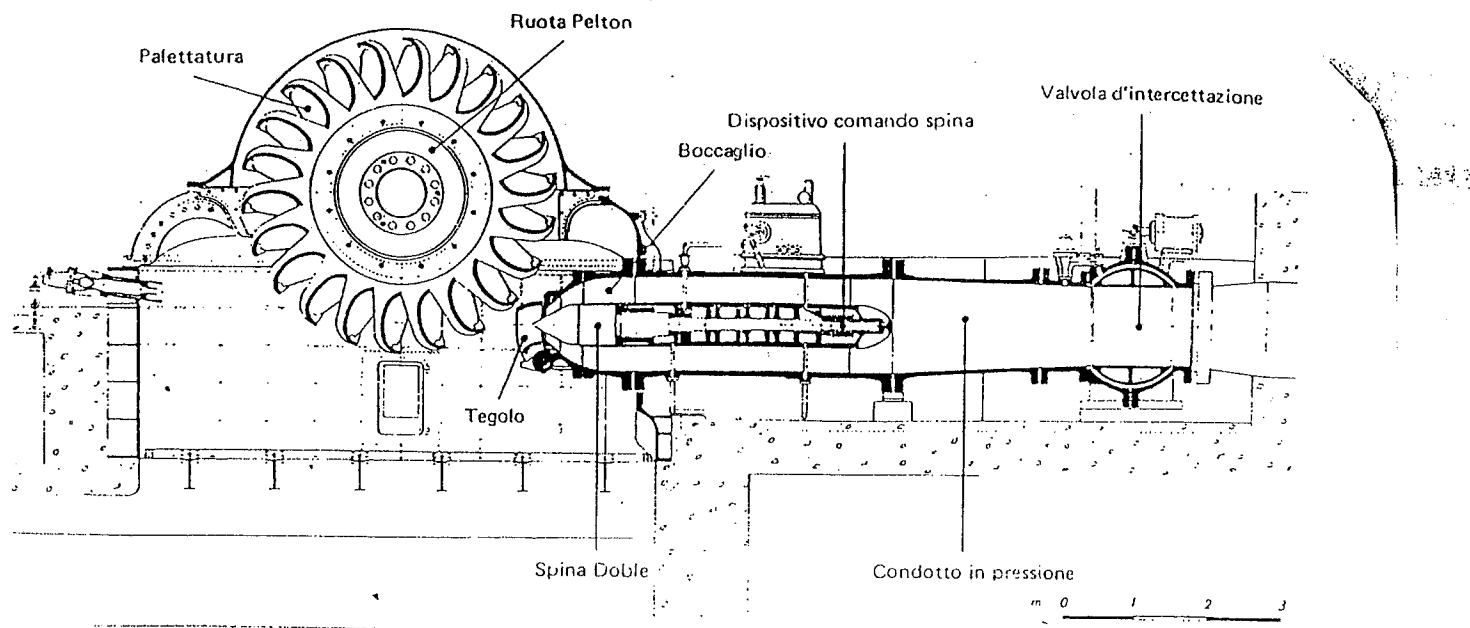

FIG. 9

mm 0 500 1000 1500 2000

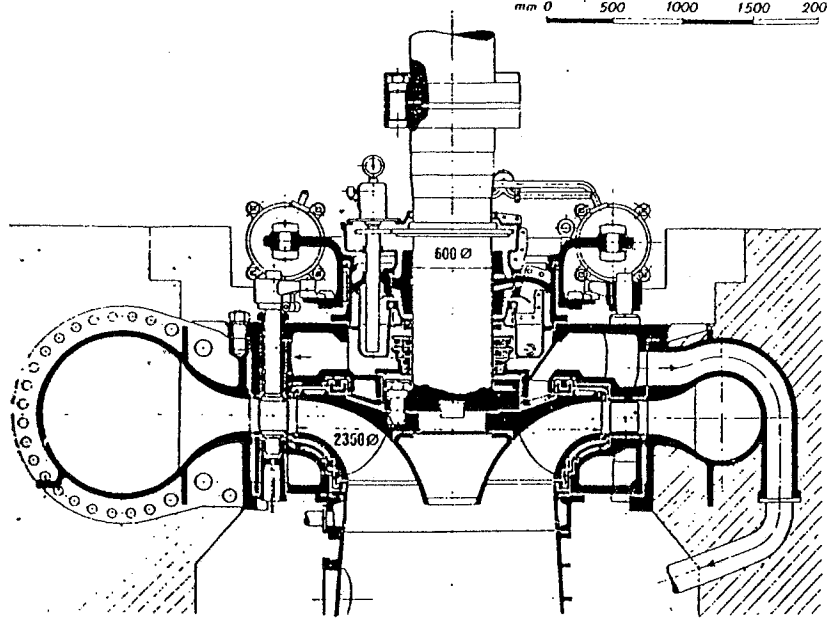
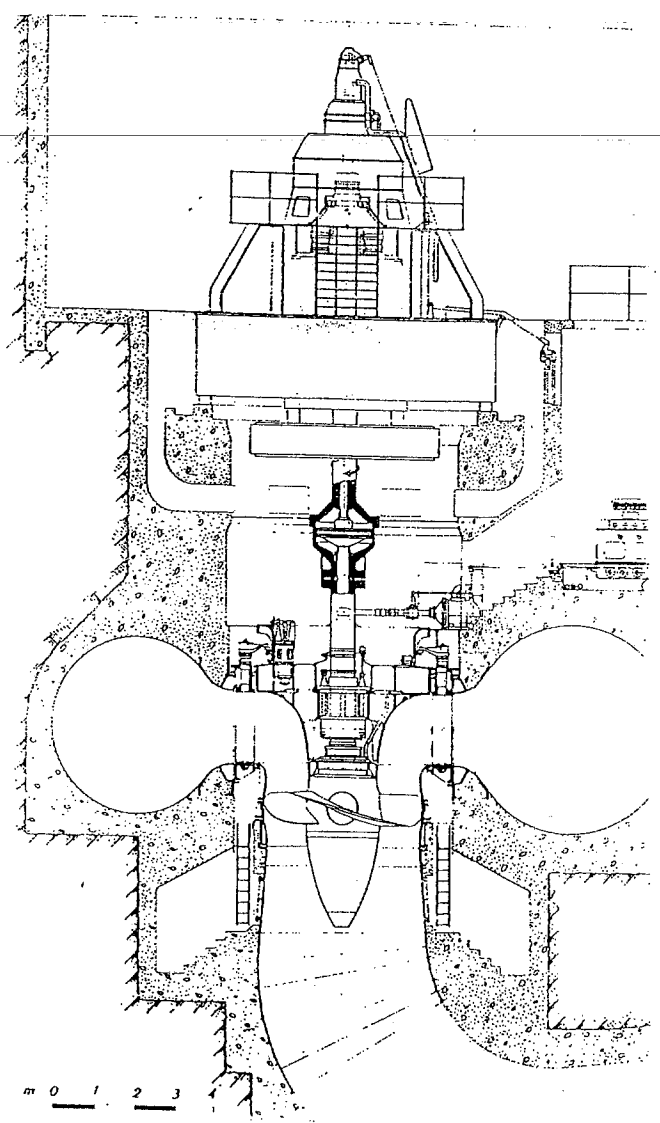
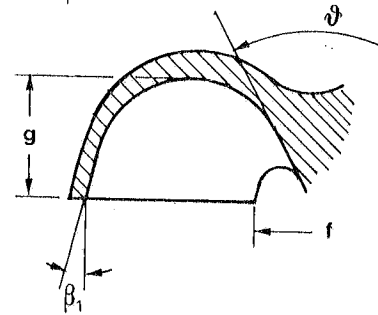
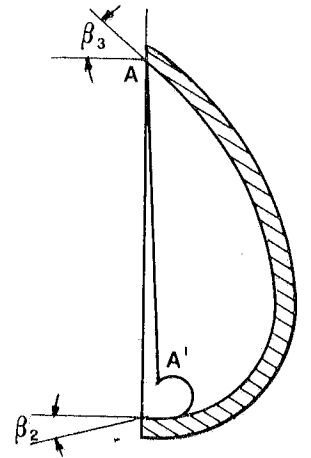
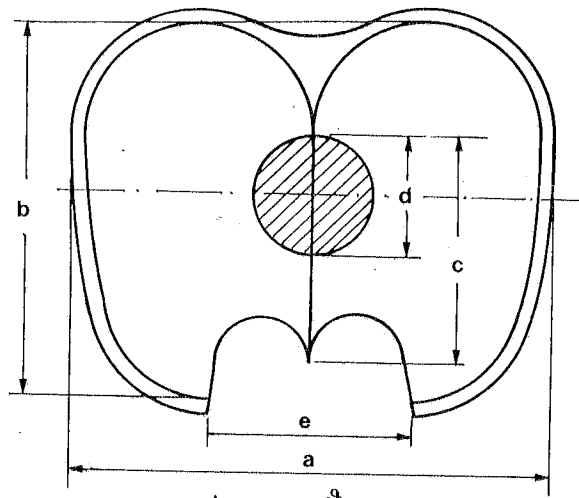
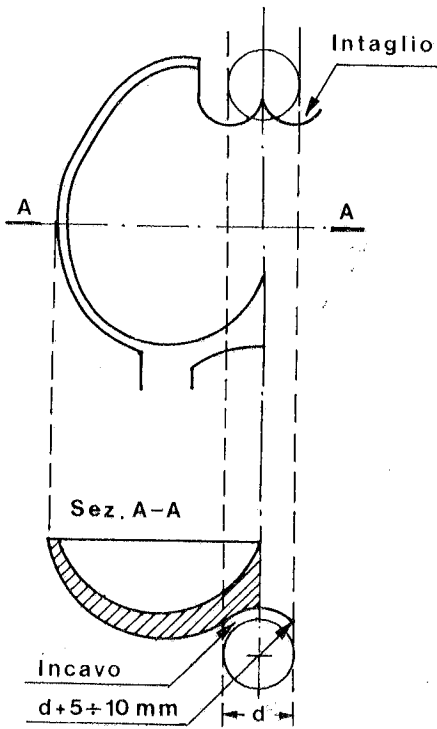
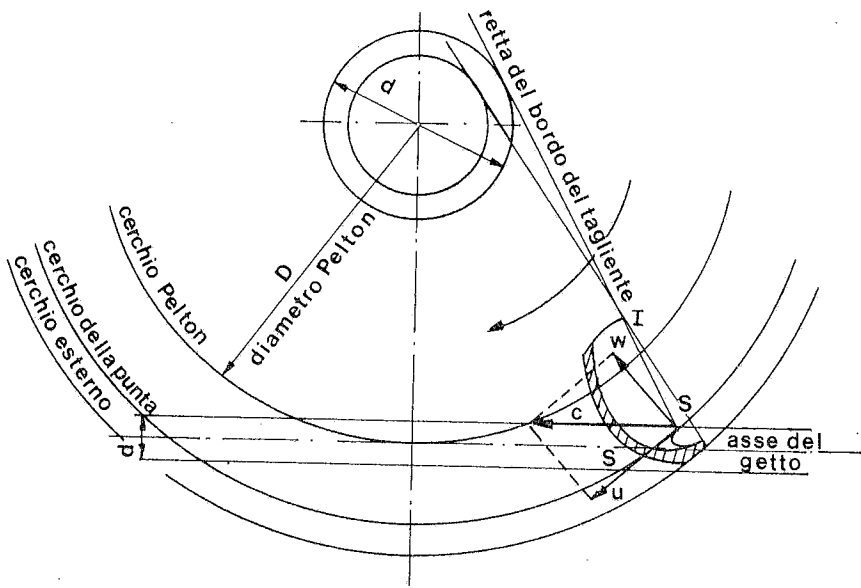

FIG. 5 - Macchina di Soverzene (Veneto)





$$\begin{aligned}
 a &= (2,7 + 3,2)d & \beta_1 &= 8^\circ + 15^\circ \\
 c &= (1,4 + 1,9)d & \beta_2 &= 25^\circ + 40^\circ \\
 e &= (1,1 + 1,2)d & \beta_3 &= 0^\circ + 45^\circ \\
 b &= (0,8 + 0,9)a & \frac{g}{a} &= 0,25 + 0,3 \\
 f &= (0,22 + 0,28)a
 \end{aligned}$$

